

# 37° JIC Flare (Nuts)

**PRESSURE CONNECTIONS CORP.**

37° JIC  
Flare (Nuts)

## 304C Tube Cap

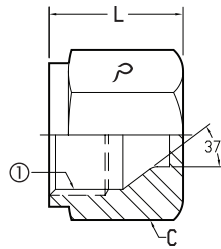

**SAE 070112**

Ref. Aeroquip 210292  
Ref. Parker FNTX  
Ref. Weatherhead C5129

304C-① ①-FJ	Tube O.D.	① Female JIC	C Hex	L Length
304C-02	1/8	5/16 - 24	3/8	0.50
304C-03	3/16	3/8 - 24	7/16	0.56
304C-04	1/4	7/16 - 20	9/16	0.59
304C-05	5/16	1/2 - 20	5/8	0.61
304C-06	3/8	9/16 - 18	11/16	0.63
304C-08	1/2	3/4 - 16	7/8	0.75
304C-10	5/8	7/8 - 14	1"	0.84
304C-12	3/4	1 1/16 - 12	1 1/4	0.91
304C-14	7/8	1 3/16 - 12	1 3/8	0.97
304C-16	1"	1 5/16 - 12	1 1/2	1.02
304C-20	1 1/4	1 5/8 - 12	2"	1.06
304C-24	1 1/2	1 7/8 - 12	2 1/4	1.19
304C-32	2"	2 1/2 - 12	2 7/8	1.44

4:1 Safety Factor

## 306N Adjustable Locknut

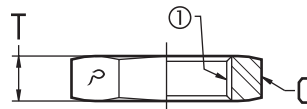

**SAE 070117**

Ref. Aeroquip 212295

Bulkhead Locknut (306) is on Page 91

306N-① Part No.	① Tube Thread	C Hex	T Thickness
306N-02	5/16 - 24	7/16	0.22
306N-03	3/8 - 24	1/2	0.22
306N-04	7/16 - 20	9/16	0.28
306N-05	1/2 - 20	5/8	0.28
306N-06	9/16 - 18	11/16	0.27
306N-08	3/4 - 16	7/8	0.31
306N-10	7/8 - 14	1"	0.36
306N-12	1 1/16 - 12	1 1/4	0.41
306N-14	1 3/16 - 12	1 3/8	0.41
306N-16	1 5/16 - 12	1 1/2	0.41
306-20 ①	1 5/8 - 12	1 7/8	0.41
306-24 ①	1 7/8 - 12	2 1/8	0.41
306-32 ①	2 1/2 - 12	2 3/4	0.41

① The Bulkhead Locknut (306) and the Adjustable Locknut (306N) are the exact same dimensions for sizes -20, -24, & -32.