

5406E

Economy Reducer Bushing

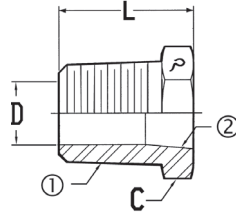

Thin Hex Not SAE

5406E-①-② ①-MP ②-FP	① Male NPT	② Female NPT	C Hex	D Drill	L Length	Operating Pressure
5406E-04-02	1/4 - 18	1/8 - 27	5/8	0.188	0.64	5,000
5406E-06-02	3/8 - 18	1/8 - 27	11/16	0.188	0.74	4,000
5406E-06-04	3/8 - 18	1/4 - 18	11/16	0.281	0.74	4,000
5406E-08-02	1/2 - 14	1/8 - 27	7/8	0.188	0.85	3,500
5406E-08-04	1/2 - 14	1/4 - 18	7/8	0.281	0.85	3,500
5406E-08-06	1/2 - 14	3/8 - 18	7/8	0.406	0.85	3,500
5406E-12-02	3/4 - 14	1/8 - 27	1 1/16	0.327	0.96	2,200
5406E-12-04	3/4 - 14	1/4 - 18	1 1/16	0.281	0.96	2,200
5406E-12-06	3/4 - 14	3/8 - 18	1 1/16	0.406	0.96	2,200
5406E-12-08	3/4 - 14	1/2 - 14	1 1/16	0.531	0.96	2,200
5406E-16-04	1 - 11 1/2	1/4 - 18	1 5/16	0.281	1.04	2,000
5406E-16-06	1 - 11 1/2	3/8 - 18	1 5/16	0.406	1.04	2,000
5406E-16-08	1 - 11 1/2	1/2 - 14	1 5/16	0.531	1.04	2,000
5406E-16-12	1 - 11 1/2	3/4 - 14	1 5/16	0.719	1.04	2,000
5406E-20-16	1 1/4 - 11 1/2	1 - 11 1/2	1 3/4	0.938	1.26	2,000

4:1 Safety Factor

5406C

Female Pipe Cap

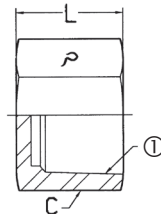

SAE J514

5406C-① ①-FP	① Female NPT	C Hex	L Length	Operating Pressure
5406C-02	1/8 - 27	1/2	0.57	5,000
5406C-04	1/4 - 18	5/8	0.66	5,000
5406C-06	3/8 - 18	13/16	0.77	3,000
5406C-08	1/2 - 14	1"	0.86	3,500
5406C-12	3/4 - 14	1 1/4	0.96	2,200

4:1 Safety Factor